

DONUT TENSIONER FOR COATED WIRE – INSTALLATION

Procedures are the same for Hotcote® and Horsecote®

A Donut Tensioner is used to complete tensioning of the fence without the need to strip, crimp or tie a knot.

Follow these easy steps to install and tension both electrifiable or non-conductive coated wire.

Prior to Installing the Donut Tensioner

- A. Attach both ends of coated wire to the end posts. [For more details see the "Horsecote® (or Hotcote®) – End Post Attachment for Coated Wire" PDF]
- B. Attach coated wire to posts at **major** rises, dips and corners. (For more details see the "Coated Wire Payout & Line Post Installation" PDF)

Determine where to position the Donut Tensioner

- On a flat terrain where there are no corners, provide one Donut Tensioner per length of fence, placed in center.
- Where terrain is not flat or there are corners, more Donut Tensioners may be required.
 - Use one Donut Tensioner for every 660' (201m) of coated wire and/or when 90° of elevation and directional change occur.
 - Corners, small dips and rises create friction so use one Donut Tensioner for every accumulated 90°.

Installing the Donut Tensioner

- ❶ Go to the middle of the section of fence to be tensioned & pull out any slack (*refer to diagram 1*). Position yourself near one of the line posts (12" to 18" (305mm to 457mm) max) and cut coated wire, removing the excess while allowing 4" - 6" (102-152mm) of overlap to remain.
- ❷ Insert ends of coated wire into Donut Tensioner (slightly past hub) from opposite sides (*refer to diagram 2*).
- ❸ Use appropriate ratchets to tighten the fence. Refer to page 2 for details on a One-Man Installation or a Two-Man Installation process.
- ❹ When desired tension is reached, insert the two locking pins into opposite holes on the Donut Tensioner.
- ❺ Where there are multiple strands of coated wire, for best appearance, attempt to align vertically near a post.

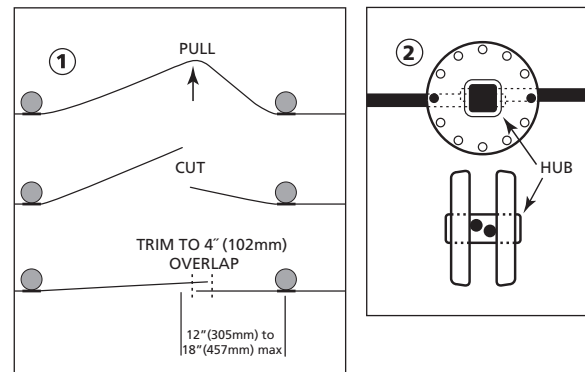
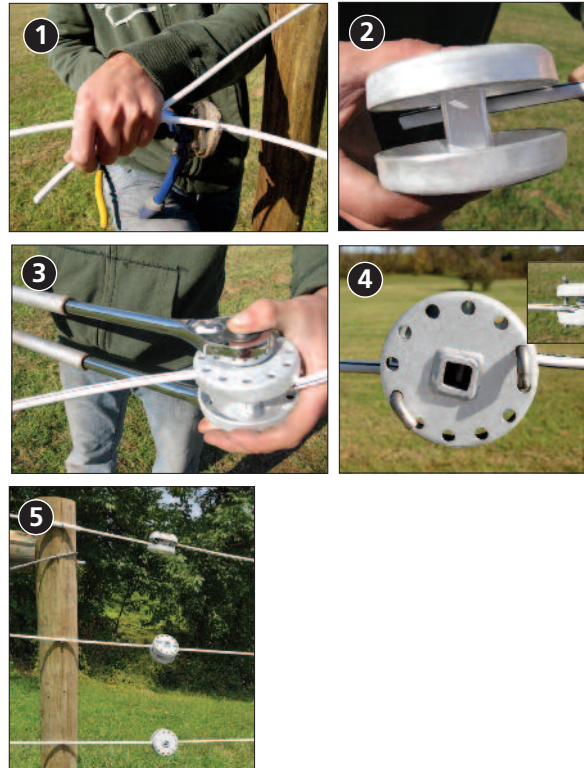

Horserail® Product

- Donut Tensioner for Coated Wire

Other Tools Needed

- Small Bolt Cutters
- Extended Handle Ratchets or Long Handle Ratchets

Other Related PDF Info Sheets

- Joining Buckle
- End Post Attachment for Coated Wire
- Coated Wire Payout and Line Post Attachment

SAFETY FIRST:

- Always use an adequate number of electric fence warning signs and make sure to attach them securely.
- It's essential to keep fence line clear of all debris. Please do not burn!

For More Details,
Tips & Techniques
on Building Fences,
Please visit our website:
www.horserail.com



Procedures are the same for Hotcote® and Horsecote®

Extended Handle Ratchets

“One-Man” Installation Process

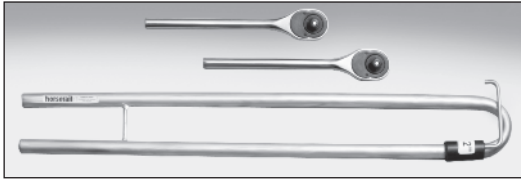

- Comes in various sizes
- Use 2" (51mm) size for Donut Tensioners
- Includes holding pin

Follow These Steps:

- Put ratchets into the top and bottom of hub.
- Slide on extended handles and remove the holding pin from the rubber strap.
- Ratchet to tighten fence.
- Use the holding pin to prevent the donut tensioner from unwinding while re-ratcheting. Repeat until taut.

NOTE:

- To keep tension, lean into Extended Handle with your body weight, then remove holding pin and insert the two locking pins into opposite holes on the Donut Tensioner.
- Remove Extended Handle, then remove ratchets.

Long Handle Ratchets

“Two-Man” Installation Process



- Comes in 18" (457mm) and 24" (610mm) lengths
- Two ratchets required

Follow These Steps:

- Put ratchets into the top and bottom of hub.
- Pull both long handles towards you.
- Hold one (a) steady while ratcheting back the other (b)
- Now hold (b) steady and ratchet back (a) and finally
- Pull both towards you again. Repeat as needed until taut.

NOTE:

- When tensioning, use two people: one to ratchet and keep tension, and one to assist with alignment and insert the two locking pins into opposite holes on the Donut Tensioner.