

HOTTOP® and HOTTOP PLUS® ELECTRIFIABLE RAIL— BASIC INSTALLATION GUIDE

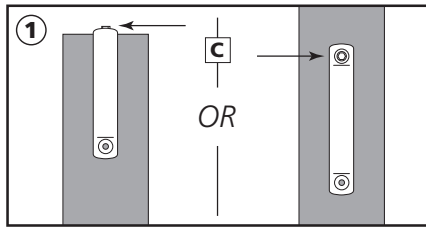

Attach brackets to line posts

- A)** Find the center tangent of each post - this will reduce binding
- B)** Use a tape measure or a marking board to locate and mark the top of each bracket - from the top down
- C)** Attach Insulator Brackets and Top Insulator Brackets - **Top hole only!**

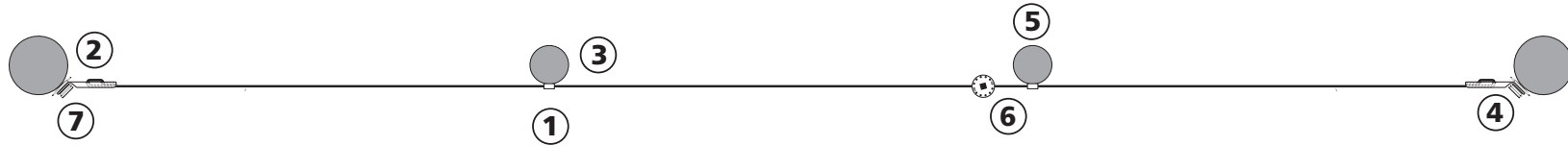
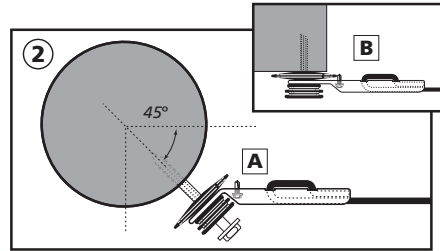

Install rail onto selected end buckle and attach to end post

- A)** Pre-Bent 45° Attaching Insulated Buckle attach at a 45 degree angle leaving the lag screw partially out
- B)** **OPTION:** Straight Attaching Insulated Buckle - for use on a flat surface such as a building - Note: tighten the lag screw
- C)** **IMPORTANT:** Do Not Overtighten!

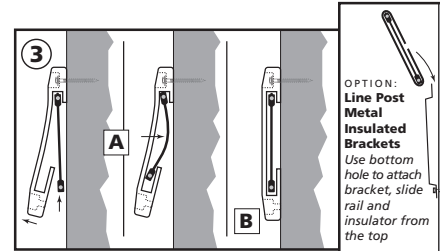

Payout rail and insert into brackets

- To best protect the rail - Use either a "Payout Box" or an oversized spinning jenny
- A)** Lift and cup rail (with thumbs) simultaneously to click in place
 - B)** Align Insulator Brackets to right angle of rail - allowing for movement

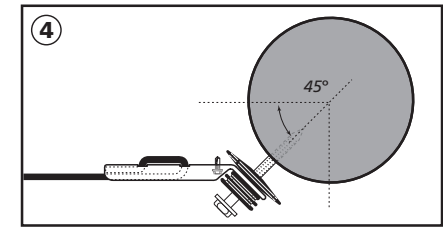

Install other end of rail using the proper end buckle

- Tighten lag screw halfway
- Leave sufficient length in rail to allow proper tensioning - see Step 6

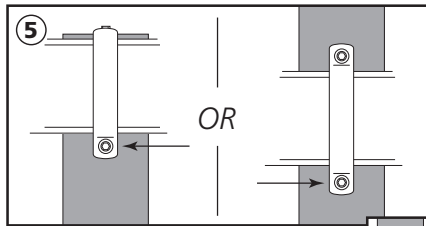

Finish attaching all brackets to line and end posts

- Bottom hole for Insulator Brackets and Top Metal Insulated Bracket
- Top hole for Line Post Metal Insulated Brackets
- Bracket must be at right angle to rail - allowing for movement

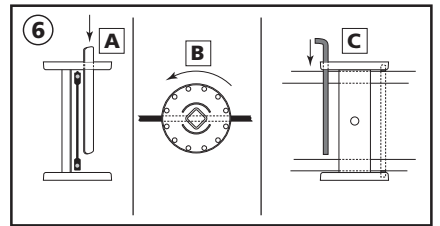

Install Spooler and tension the fence

For aesthetics - place Spooler 12" (305mm) min. from line post

- A)** Place Spooler on rail and slide "removable" hub piece into place
- B)** Allow for one full rotation before becoming taut
- C)** Place locking pins into pre-drilled holes, opposite each other, to stop the Spooler from unwinding

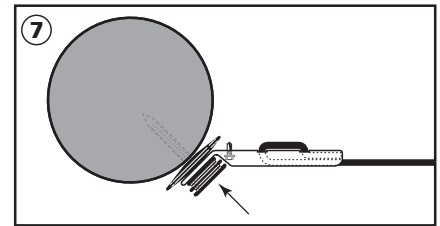

Complete your fence installation by fully tightening the lag screws from Step 2 and Step 4 - this will also further tension the rail!

- **IMPORTANT:** Do Not Overtighten!

Use a Joining Buckle to join two rail sections together



HARDWARE AND ACCESSORIES

INSULATOR SCREWS: Use Wide Shoulder #8 - 2" minimum; 5/16" (#8 - 50mm minimum; 8mm) Hex Head Drive Screws Only

LAG SCREWS: 1/2" x 4" thru 6" (12mm x 100mm thru 150mm)

BENDING TOOL: for Simplicity and Neatness The perfect tool for bending rail to the optimum shape and dimension

EXTENDED HANDLE RATCHETS: Used for a "One-Man" Installation Process!

LONG HANDLE RATCHETS: Used for a "Two-Man" Installation Process!

For More Details, Tips & Techniques on Building Fences, Please visit our website:

www.horserail.com

SAFETY FIRST: USE SAFETY EYE GLASSES AND GLOVES.