

# Insulated T-Buckle Installation

TO BE USED WITH: HOTTOP® & HOTTOP Plus® (Electrifiable Rail)

Our selection of **Insulated T-Buckles\*** is the perfect hardware to create a fence that runs perpendicular to another fence. If the area is flat you can use the **Fixed Insulated T-Buckle** and if your terrain has a slight rise or dip you can use the **Adjustable Insulated T-Buckle**.

Included with every **Insulated T-Buckle** is our hi-performance, reliable and simple to install **Clip-On Electric Connector**. It eliminates the need to cut/splice/strip or any other form of degradation to the rail. The connector allows you to easily add electricity to the new fence line.

Available In:



4.25" (108mm) & 5.25" (133mm)

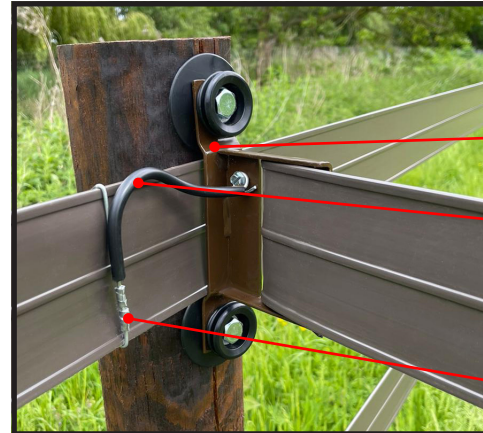

Fixed Insulated T-Buckle

Electric Lead-out

Clip-On Electric Connector

## \* Insulated T-Buckle SELECTION

- Fixed Insulated T-Buckle
- Adjustable Insulated T-Buckle
- Fixed Top Insulated T-Buckle
- Adjustable Top Insulated T-Buckle

*Top Insulated T-Buckles are for when you want the top rail to be flush with the top of the post*

## Other Tools Needed

- Crimping Tool

### Fixed Insulated T-Buckle Installation



### Adjustable Insulated T-Buckle Installation

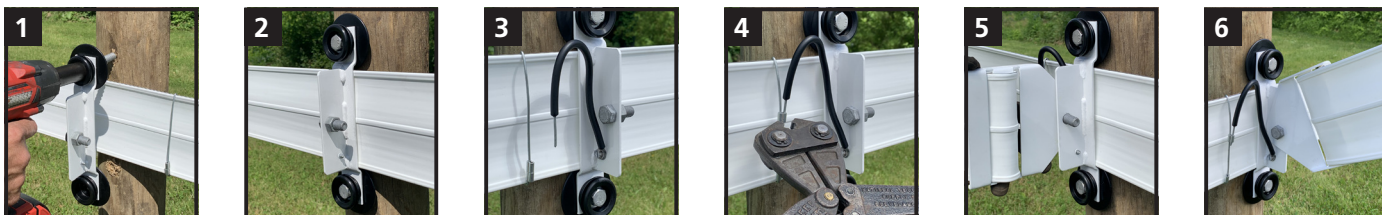

Hardware is **Double Coated**  
for Superior Weather Resistance:  
*E-Coat and Powder Coat*

- **WARNING:** Only for use with low-impedance electric fence energizers!
- Always use an adequate number of electric fence warning signs and make sure to attach them securely.
- It's essential to keep fence line clear of all debris. Please do not burn!

  
**horserail**  
Just...buckle it up!



horserail.com



Scan For  
Additional  
Installation  
Instructions

Copyright © 2021 John Wall, Inc. All Rights Reserved.

Horserrail®, Hottop®, Hottop Plus®, Horsecote®, Hotcote®, and Safe-T-Brace Cable® are registered U.S. trademarks of John Wall, Inc. Please visit [horserail.com](http://horserail.com) for a complete list of trademark and patent information.

**SAFETY FIRST: USE SAFETY EYE GLASSES AND GLOVES.**

JW19990\_ITB\_082022